

ALTUS

Sky is my Home

Performance	Imperial	Metric
Never Exceed Speed (V_{ne})	146 knots	270 km/h
Maneuvering Speed (V_a)	97 knots	180 km/h
Rough Air Speed (V_{ra})	121 knots	225 km/h
Range	860 NM	1600 km
Fuel tank	26.4 gallon	100 liter
Take off distance	490 feet	150 m
Climb rate	1400 ft/min	7 m/s
Luggage	110 pounds	50 kg
Maximum TOW	1320 pounds	600 kg
Wingspan	36/49 feet	11/15 m
Gliding Ratio	1:24	
Load factor	+5.3 / -2.65 G	
Engine	ROTAX 912 ULS	

FEATURES

- **5 FAI World Records**
- **Designed for friendly flight and stall characteristics**
- **New generation airfoil**
- **Easy maintenance**
- **Exclusive custom interior and exterior designs**
- **Variable wingspans**
- **XXL Luggage compartment**
(place for 2 electric scooters)

ALTUS

WWW.ALTUSAERO.COM

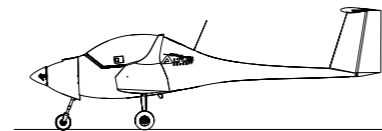

ALTUS

Sky is my Home



*"Made in **Europe**"*

*"Assembled in **Hungary**"*

ALTUS

CREDO

I was born to give You freedom, to stop the daily rush, and bring You to breathtaking sceneries. Safe, fast and simple. You can turn off the engine of the aircraft and fly me hundreds of kilometers in silence, with the power of nature. Or we can just cross mountains over 4000 meters. It is all up to You.

*"For many of us the sky is the limit,
for some of us the sky is not the limit,
for me the sky is home"*

We use only the finest materials and the most advanced tools and technical solutions to build our aircraft. Galaxy rescue system is

standard equipment. To make Altus the best Touring Motorglider, we designed the cargo compartment big enough to fit 2 electric scooter and extra bags for a perfect tour. 50 kg luggage is allowed to carry.

The story started in 2014 when we decided together with Omikron Dokk Kft. to build a low wing fuselage, as there was no modern touring motorglider on the market with good visibility and the required interior space and design.

Sky is my Home



"Altus means Altitude"





DREAMER OF CONCEPT

The good aircraft have friendly flight and stall characteristics. Having nice performance in addition was the real challenge.

Krisztian **Dolhai**
The dreamer of the concept

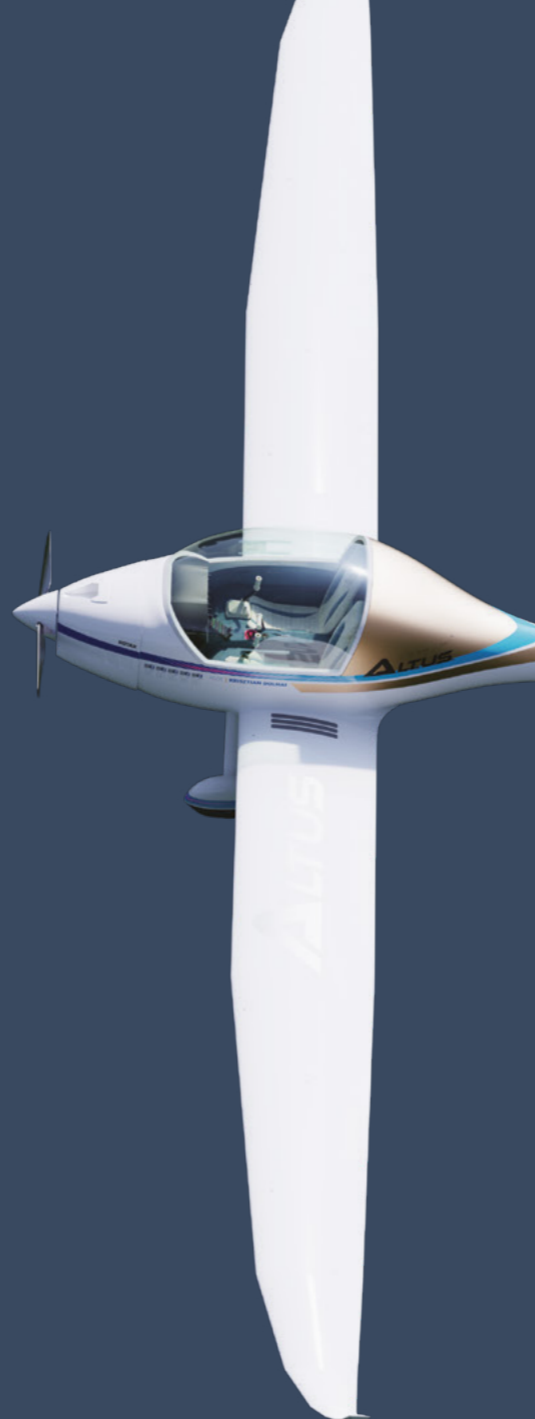

PROFILE

- Vehicle design engineer
- Multiple FAI World Record Holder
- FAI European Microlight Champion
- FAI World Microlight Vice Champion
- FAI Ann Welch Diploma Owner

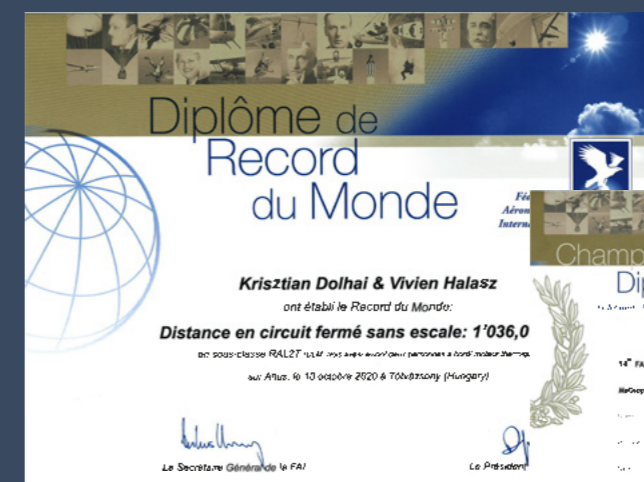
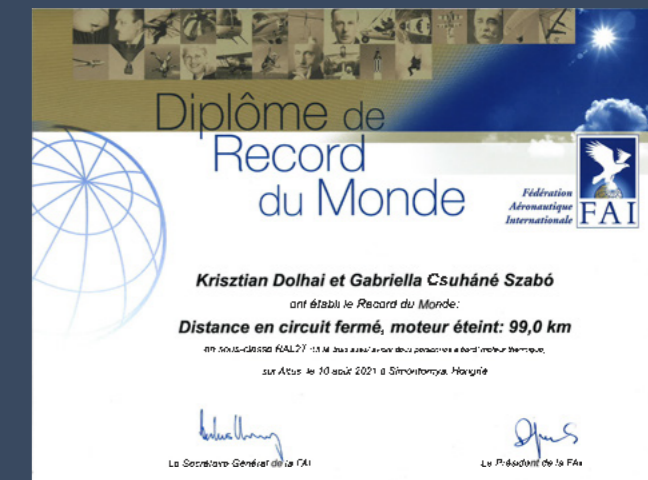
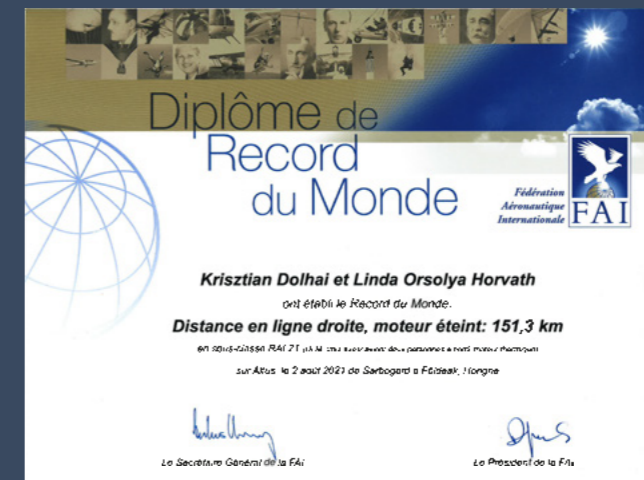
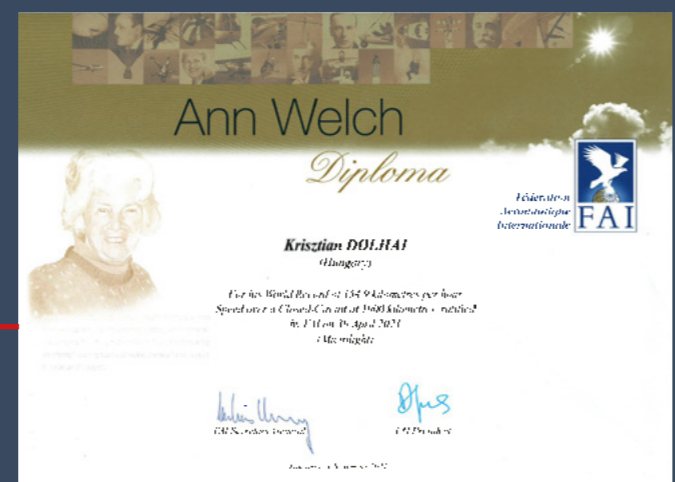

ALTUS

Performance	Imperial	Metric
Never Exceed Speed (V _{ne})	146 knots	270 km/h
Maneuvering Speed (V _a)	97 knots	180 km/h
Rough Air Speed (V _{ra})	121 knots	225 km/h
Range	860 NM	1600 km
Fuel tank	26.4 gallon	100 liter
Take off distance	490 feet	150 m
Climb rate	1400 ft/min	7 m/s
Luggage	110 pounds	50 kg
Maximum TOW	1320 pounds	600 kg
Wingspan	36/49 feet	11/15 m
Glide Ratio	1:24	
Load factor	+5.3 / -2.65 G	
Engine	ROTAX 912 ULS	

"The easily removable wingtip makes Altus a conveniently variable model"



KEY FEATURES

- **Easily changeable** wing extensions (36/49 feet, 11/15 m)
- **5** FAI World Records
- Designed for **friendly** flight and stall characteristics
- **New** generation airfoil
- **Easy** maintenance
- **Exclusive** custom interior and exterior designs
- **XXL** Luggage compartment
- **GRS Rescue Parachute System** is standard equipment.
- **Cobra trailer** is available customised to Altus

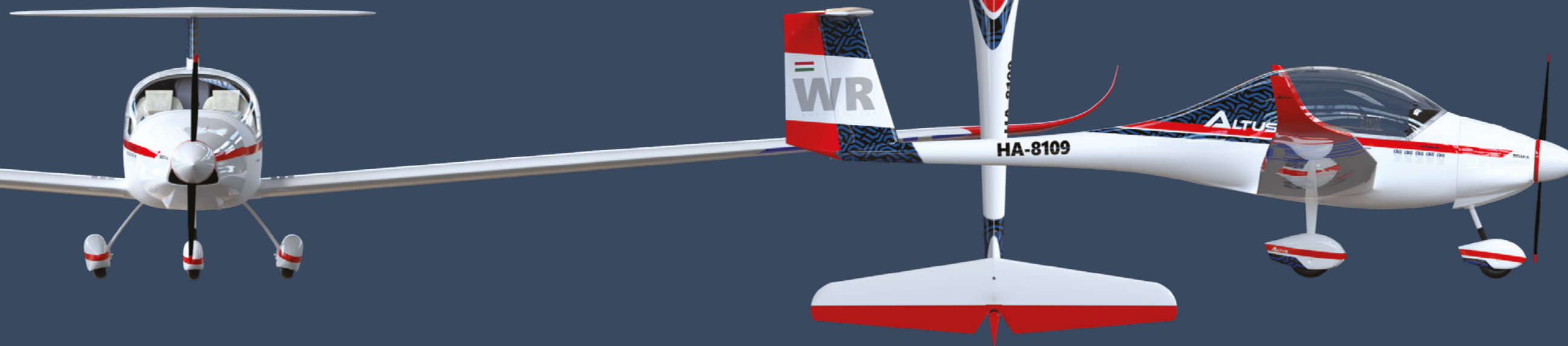

ALTUS

"Which one would You choose"

TRICYCLE

TAILDRAGGER





ELECTRIC | SCOOTERS

There is no need to rent a car or call a taxi around smaller airports. We can use the two electric scooters that come with the plane as an option to get you conveniently into town or to your destination in the area.

The aircraft has a large baggage compartment with a load capacity of **50 kg (110 lbs)**, providing a comfortable ride for true touring pilots.

"Scooting on the beach with my son at the weekend and flying home the next day was an unforgettable experience."



"XXL Luggage Compartment"

2 ELECTRIC **SCOOTERS**

ALTUS

SAFETY ADVANTAGES

1. In the event of an engine stop or propeller failure after bird strike we can glide to the nearest airfield. The ideal and safe arrival altitude is at least 300 metres to fly a traffic pattern. Calculated with these parameters, flying at a 2300 m, it is sufficient to have airfields every 100 km along our route.

2. The other advantage of Altus, that we climb 3 times faster during takeoff, than we are descending with engine off. This allows us to glide back to our airfield where we departed from anytime before we reach our cruising altitude.

3. With its strong airbrakes fully extended, Altus is able to sink 12 m/s at cruising speed, so we can come down from 1200 m height above ground level in 100 seconds.

4. If there is no airfield in our engine off range, we can glide 15 minutes from 1200 m while we are looking for a suitable field for landing.

5. If there is no place for landing, we can activate the GRS system, and the 115 m² parachute brings down

AIRFIELD-TO-AIRFIELD SAFE DISTANCE ESTIMATION				
In case of an engine cut off you can glide to the next safe airfield.				
Options	Imperial	Metric	Imperial	Metric
Cruising Altitude 1.	7500 feet	2300 m	54 NM	100 km
Cruising Altitude 2.	4000 feet	1300 m	27 NM	50 km
Cruising Altitude 3.	2600 feet	800 m	13.5 NM	25 km

the aircraft including its passengers, there is no need to jump.

6. Altus is designed with a reinforced cockpit structure for increased safety.

"Climbing to 4000 feet usually take only 5-6 minutes"

"Fast climbing and gliding capability of the aircraft greatly increases safety and provides a more relaxed route and touring experience."

Airport - A
We arrive at an altitude of at least 300 meters

AIRFIELD-TO-AIRFIELD SAFE DISTANCE

Airport - B
We arrive at an altitude of at least 300 meters

EXTRA SAFETY BY GLIDING CAPABILITY

NOTE: The range of the glider in a given situation depends on the wind direction and speed, the terrain, the weight of the aircraft and the chosen airspeed, weather conditions etc.



SOLAR HANGAR | CONCEPT

The concept allows you to can optionally temper the hangar and keep the aircraft in a constant temperature range with air conditioning. The energy generated by the solar panels can be used not only for this purpose, but also for charging the electric scooters, and the aircraft's battery.

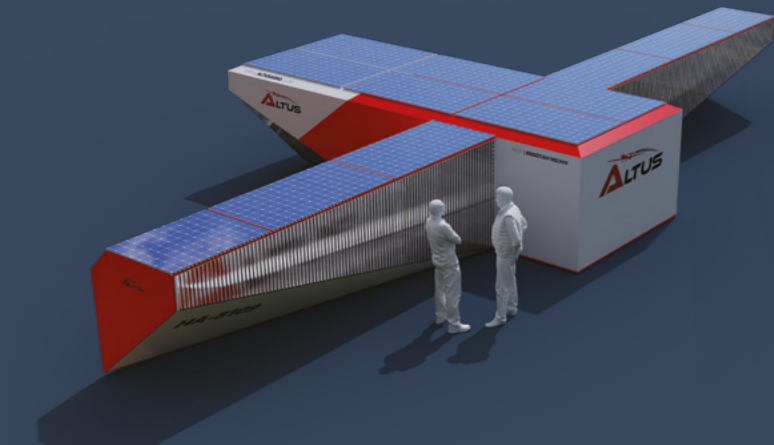

The hangar can be easily opened and closed and is weatherproof. It can also be used to conveniently store aircraft tools and maintenance equipment.

It can be moved by trailer. Installation is quick and easy.

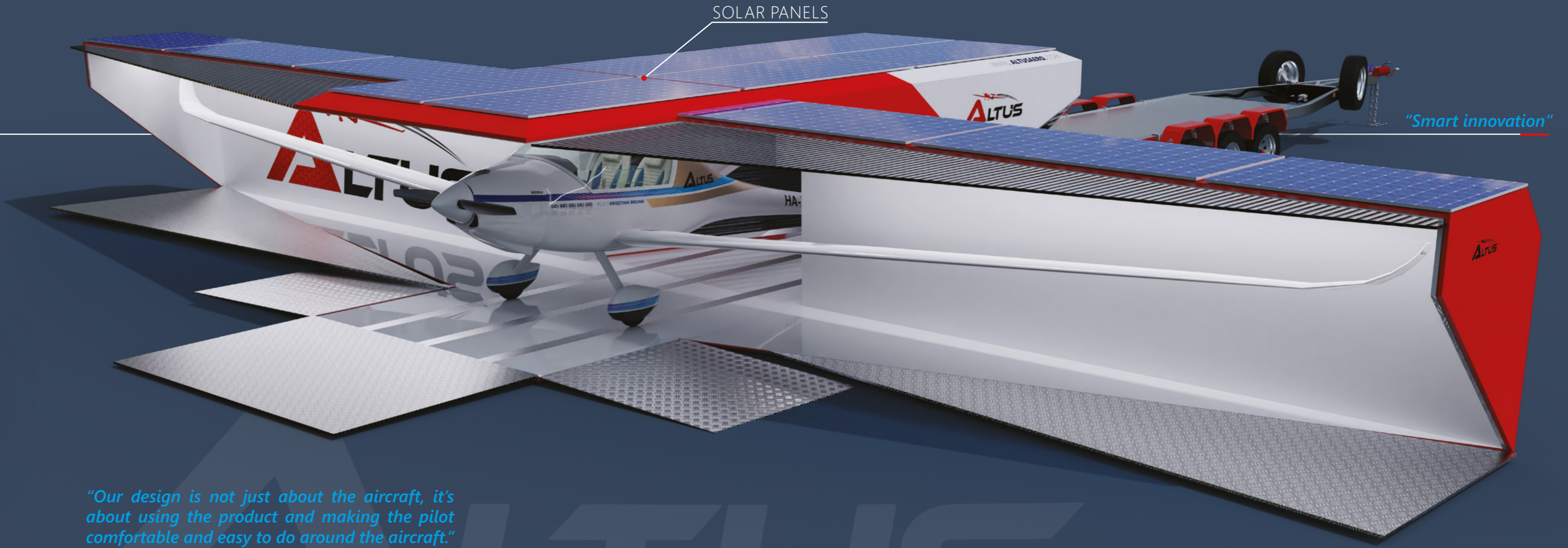

"Our design is not just about the aircraft, it's about using the product and making the pilot comfortable and easy to do around the aircraft."

- **COBRA** trailer is also available and customised to ALTUS
- We provide **exclusive** exterior design for our SOLAR HANGARS and Cobra trailers

ALTUS



"Safety, Design and Innovation hand-in-hand."

DESIGNERD FOR **FRIENDLY FLIGHT AND STALL CHARACTERISTICS**

We use only the finest materials and the most advanced tools and technical solutions to design and build our aircraft. Galaxy rescue system is standard equipment. To make Altus the best Touring Motor glider, we designed the cargo compartment big enough to fit 2 electric scooter and extra bags for a perfect tour. 50 kg luggage is allowed to carry. Thank to the excellent aerodinamical design, Altus has no intention to spin after stall, and recovering is smooth and fast.



Sky is my Home ✈️

The ALTUS logo is positioned in the top left corner, featuring a stylized white 'A' followed by the word 'LTUS' in a bold, italicized sans-serif font. The background of the entire image is a photograph of a white Altus aircraft on a runway, with a town and mountains in the distance. The aircraft has 'HA-KDK' on the tail, 'EXPERIMENTAL' on the fuselage, and 'E-props' on the propellers. The scene is set on a clear day with a blue sky and green fields.

BORN TO **CROSSCOUNTRY FLIGHT**

Touring is a dream for many of us. To achieve this, we need a safe and powerful aircraft that can fly long distances efficiently and quickly. With the high glide ratio, we can easily reach any surrounding airport from cruising altitude, even in glider mode. The ALTUS offers a solution to this.

ALTUS

RECREATIONAL FLYING

Flying only for fun is the dream of all pilots. Even if flying is a symbol of freedom, there are many strict rules and regulations to follow. Altus was born for recreational flying, where operating the aircraft shall take as little effort and focus as possible.

The pilot will have more time to concentrate on his other flight duties (Airspaces, Weather, Traffic), and of course to enjoy the breathtaking view from the sky.

The high stability, simple cockpit, fixed landing gear, and ground adjustable propeller makes Altus easy to fly.

"Flying only for fun is the dream of all pilots."

The side by side seat arrangement provides more direct communication and enables friends or guests to feel more comfortable. The high canopy position gives slightly more drag, but we decided for the best visibility.

You can taxi on the ground with the tailwheel version straight, no need for the S-turns to see what is in front of the aircraft. Double controls make tasting and learning of flight possible.

Sky is my Home



ALTUS

"Good design is essential."

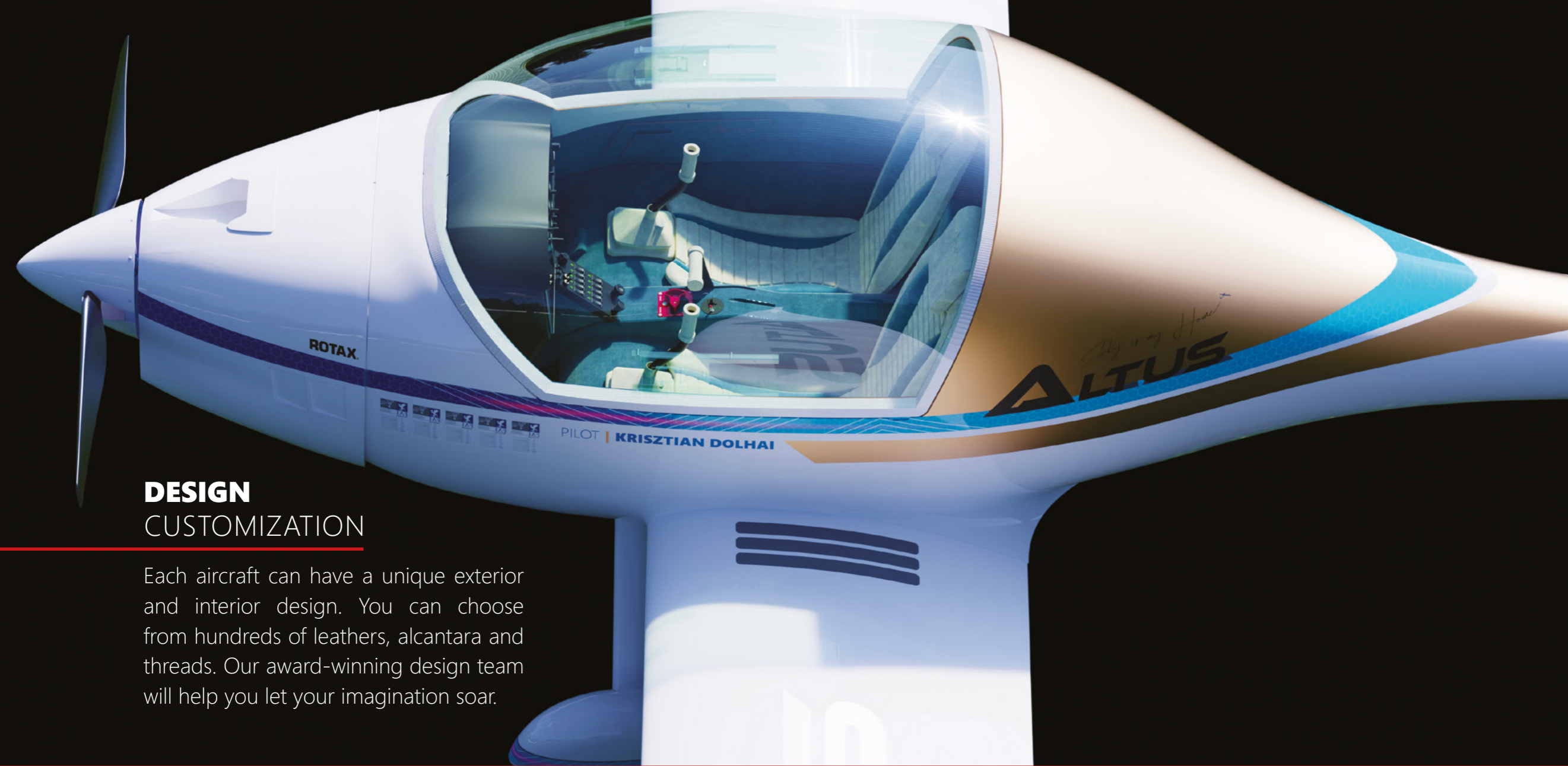

DESIGN CUSTOMIZATION

Each aircraft can have a unique exterior and interior design. You can choose from hundreds of leathers, alcantara and threads. Our award-winning design team will help you let your imagination soar.



ALTUS

ALTUS MILITARY



ALTUS DRONE



ALTUS TRAINER



Sky is my Home

ALTUS

EASY | MAINTENANCE

Manufacturer Customer support is very important to us. At the same time, we have made every effort during development to ensure that all components are as simple, durable and maintenance-free as possible. This design philosophy has many long-term benefits for Altus owners.

"We fly to You!"



Sky is my Home ✈️